

# Mounting instructions

Side bar series: GM - GC- RM - RC - BM - BC

## **Ford Transit 2014+ Frontwheeldrive Ford Custom 2012+**



SW13 (23 Nm)



SW17 (46 Nm)

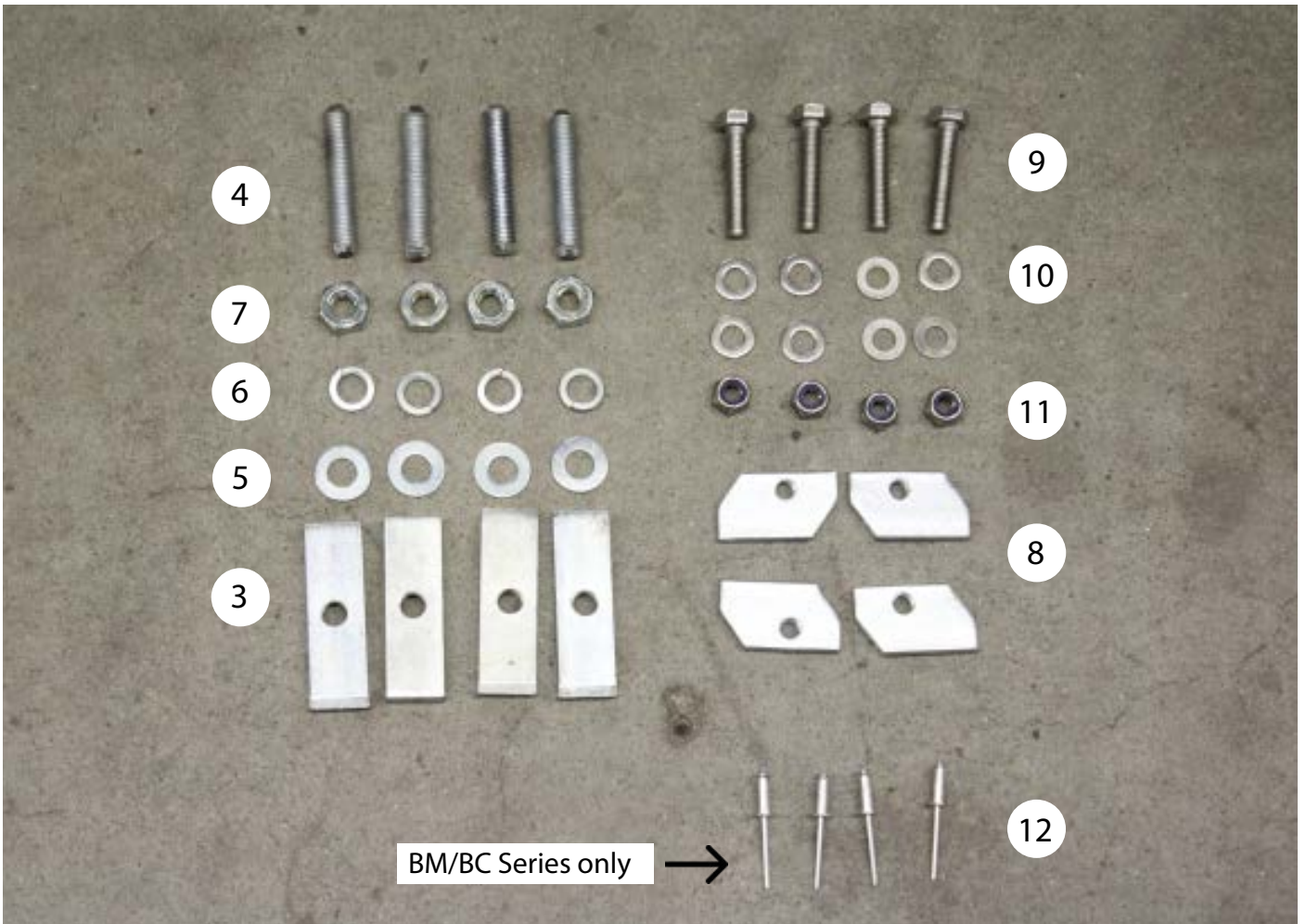


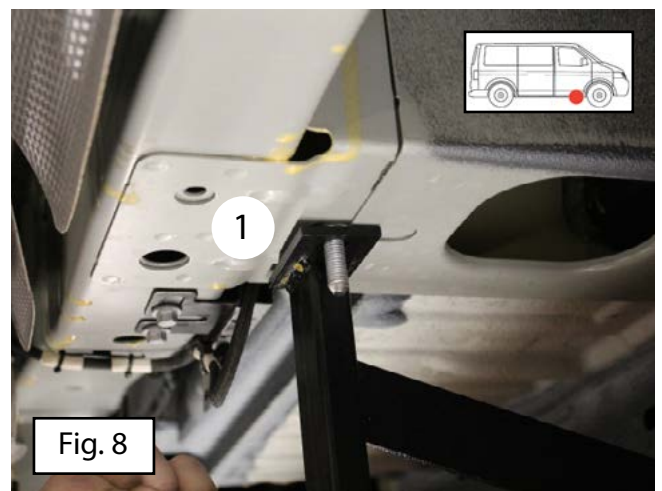
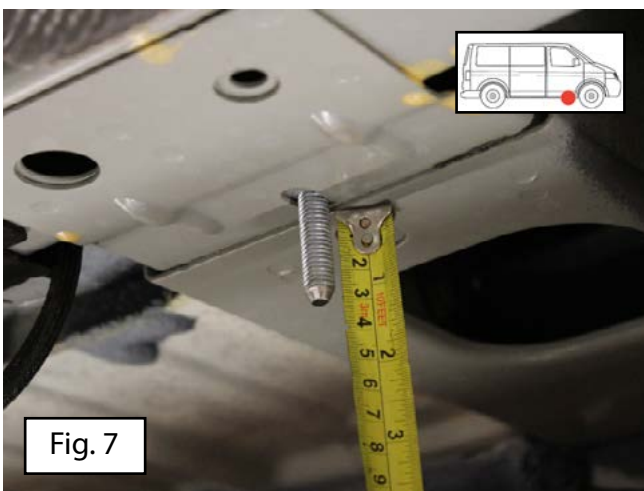
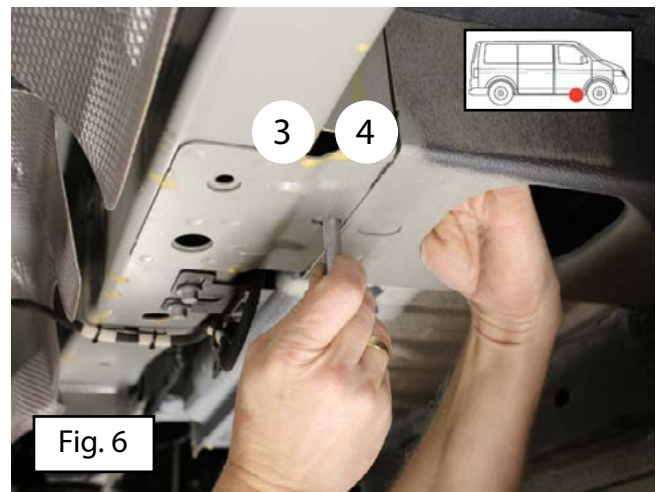
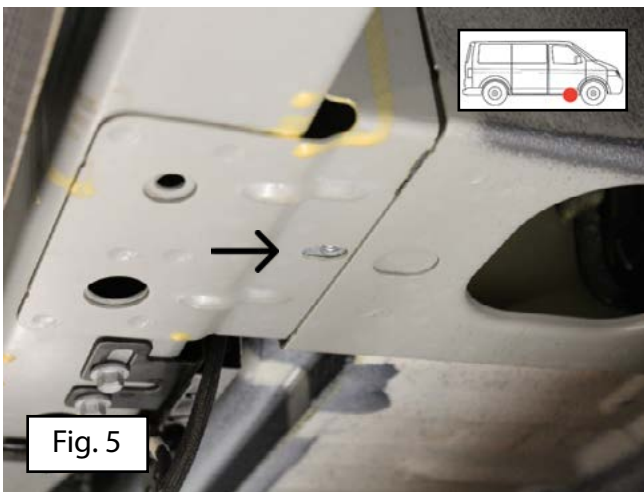
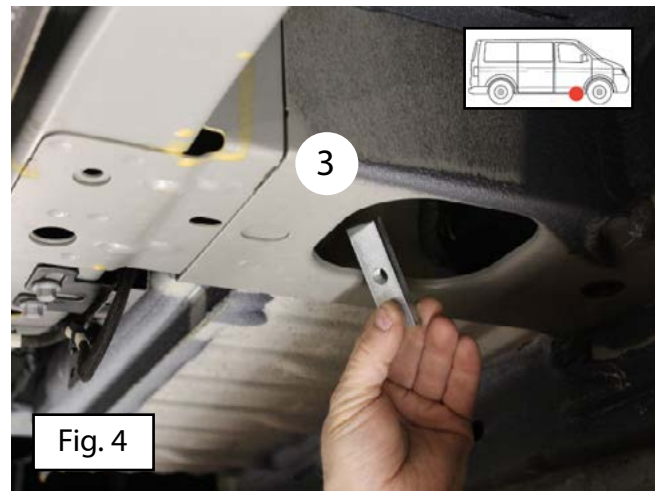
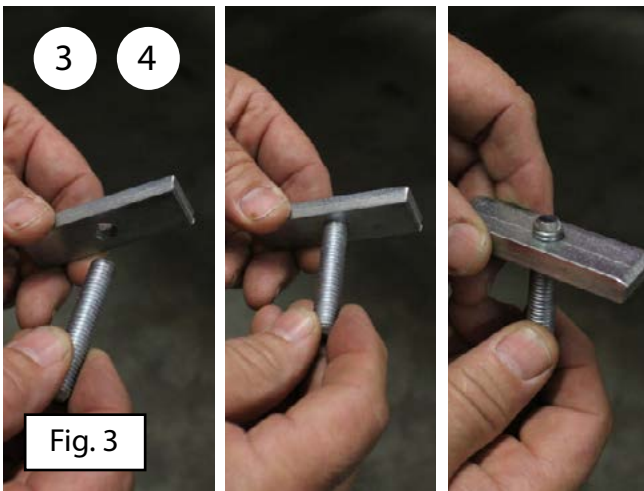
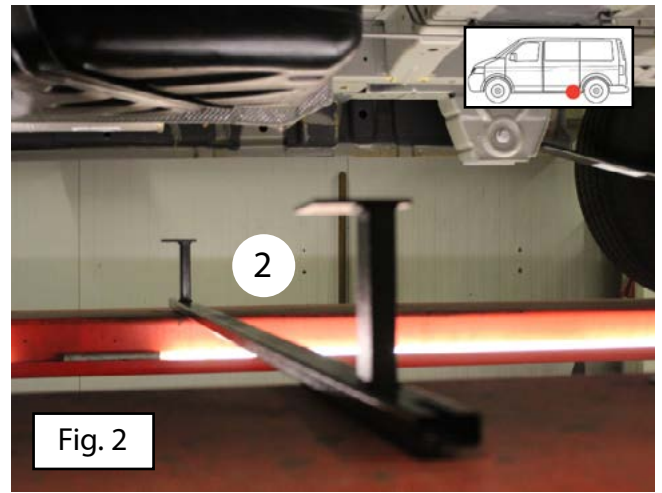
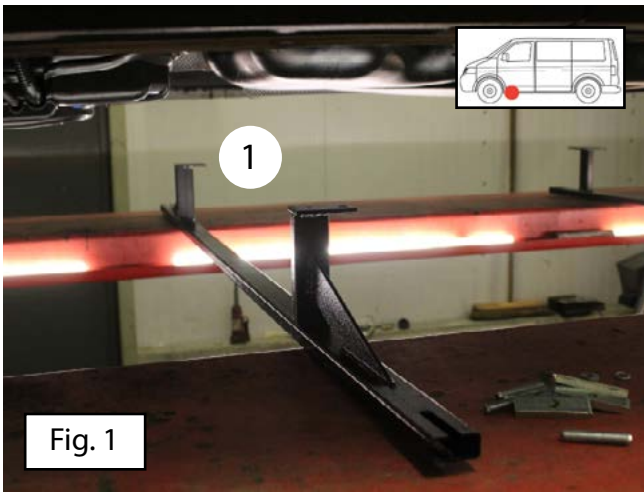
45 Min.

Version: October 2017









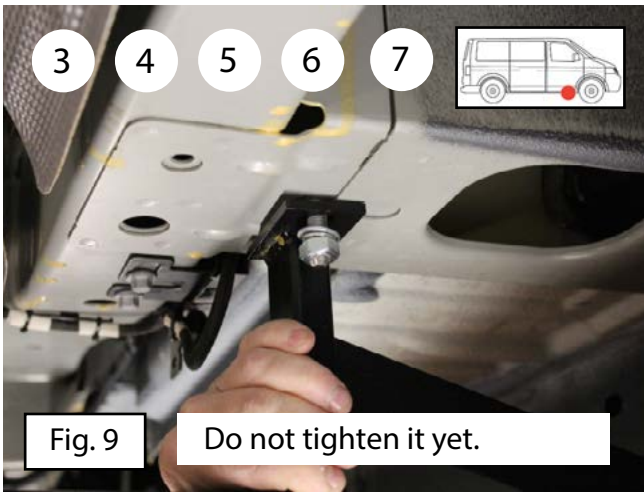


Fig. 9 Do not tighten it yet.



Fig. 10

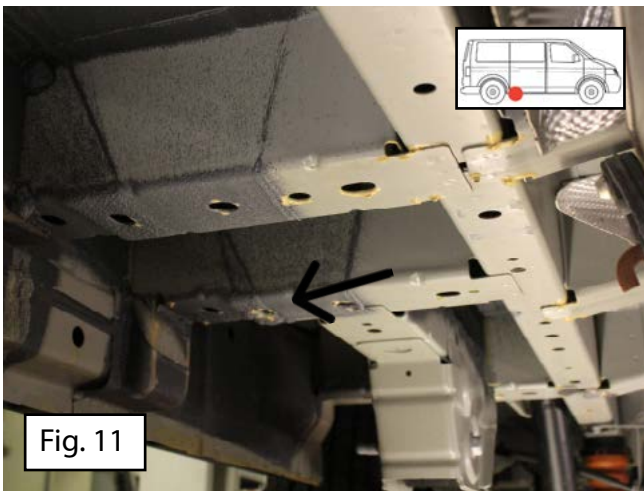


Fig. 11

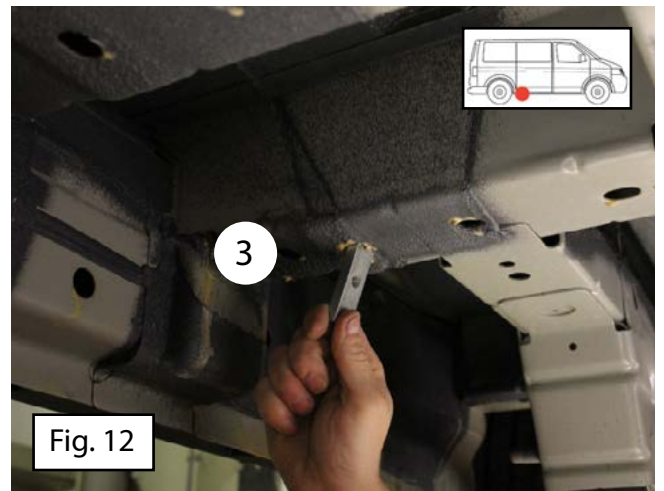


Fig. 12

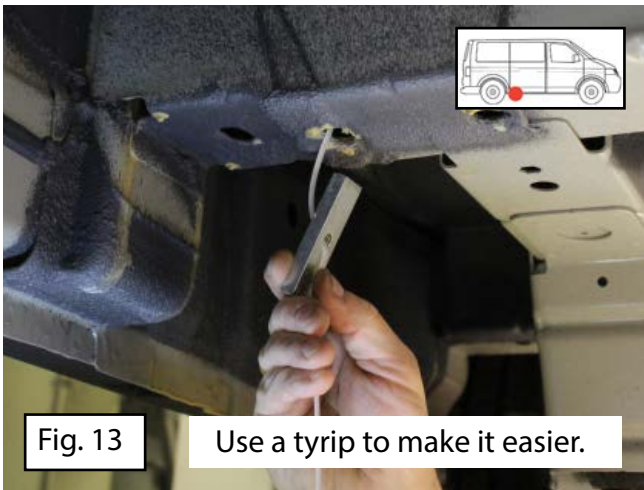


Fig. 13 Use a tyrip to make it easier.



Fig. 14

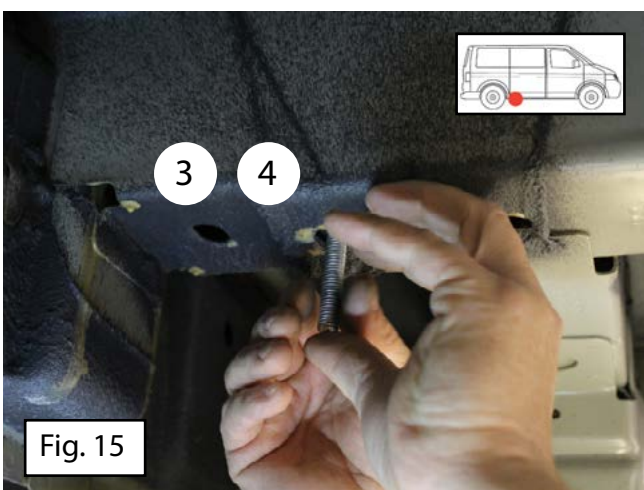


Fig. 15

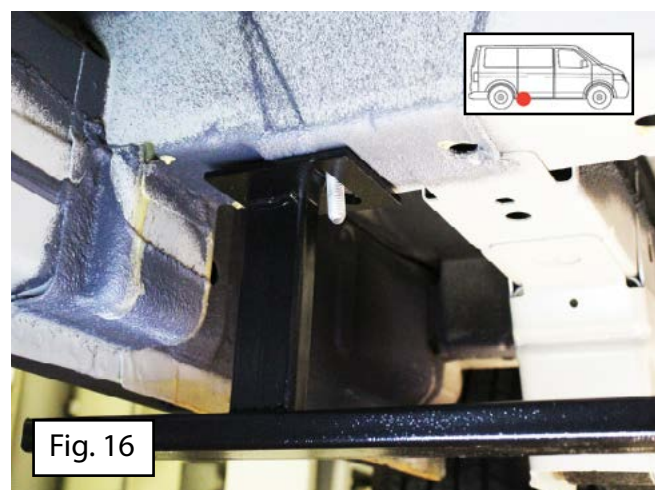
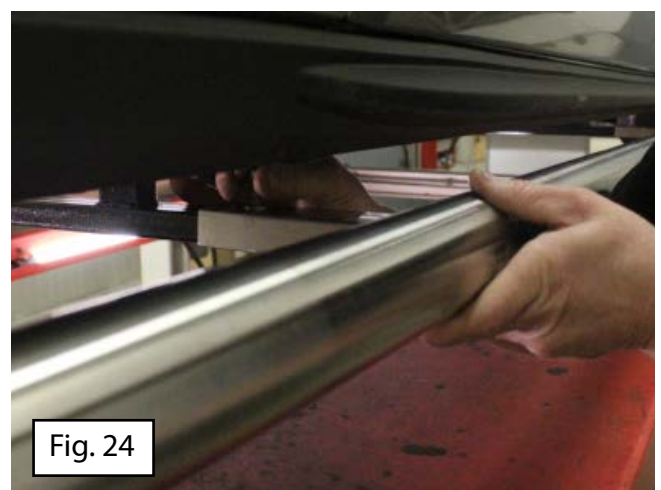
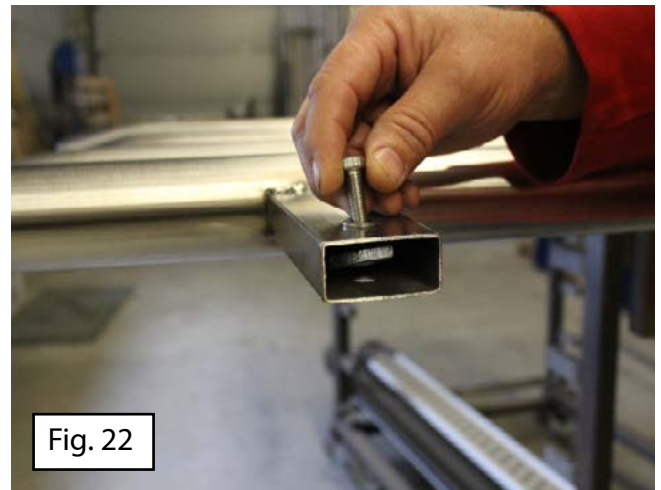
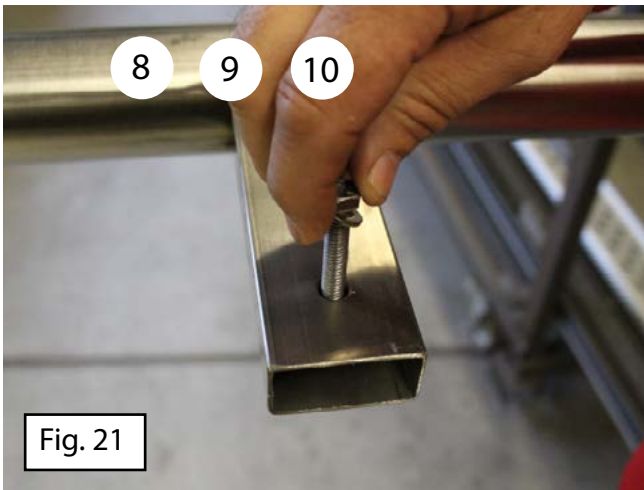
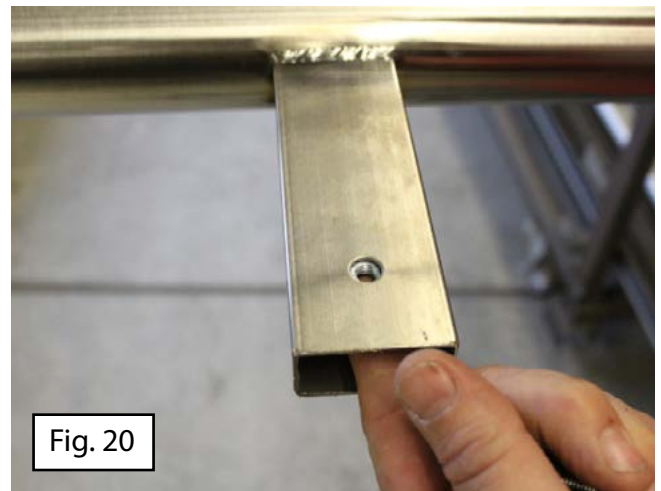
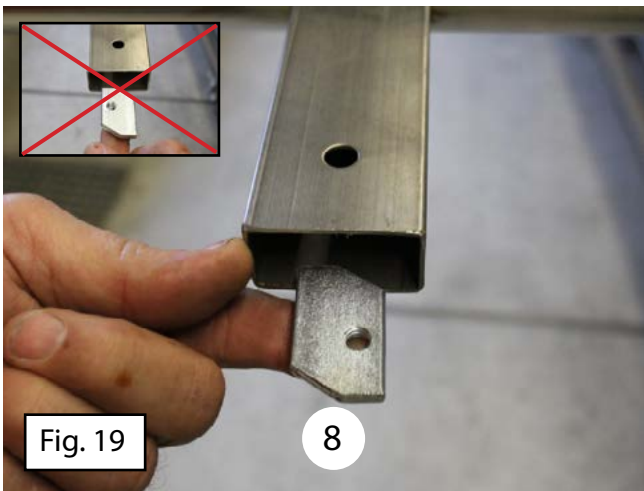
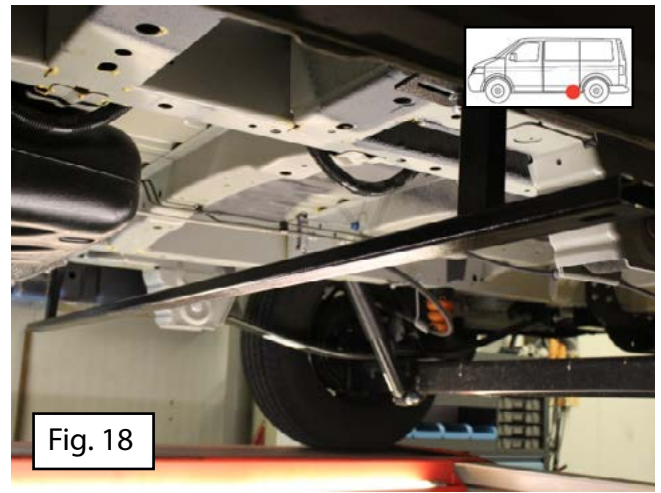
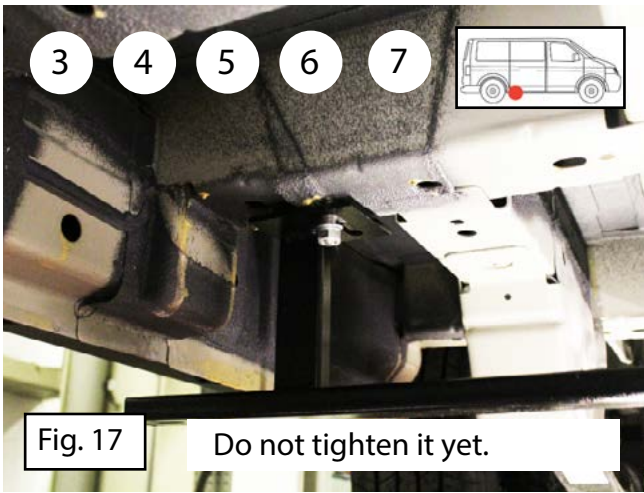


Fig. 16



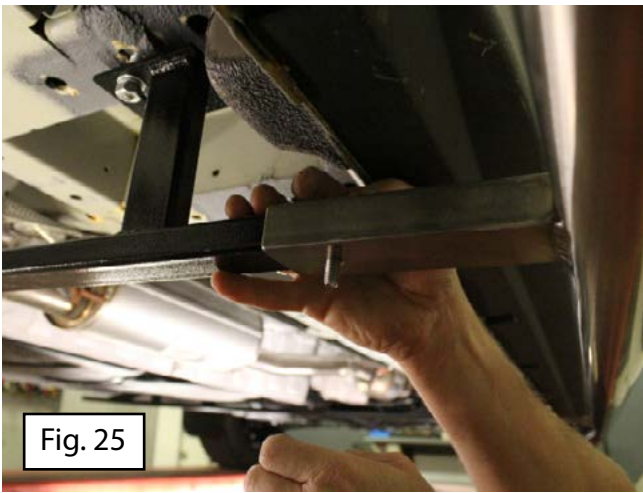


Fig. 25

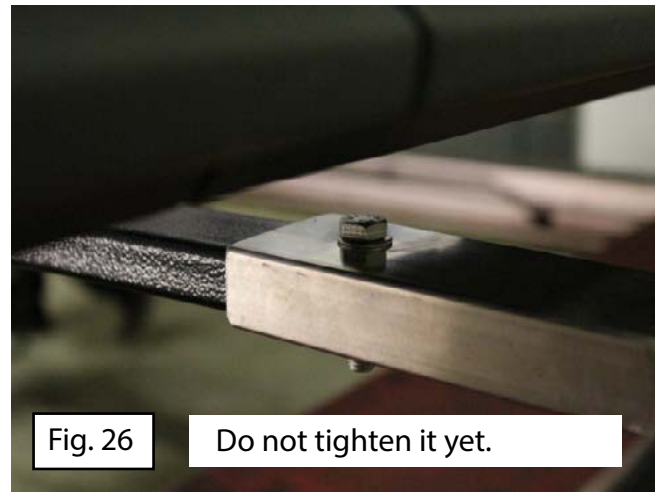
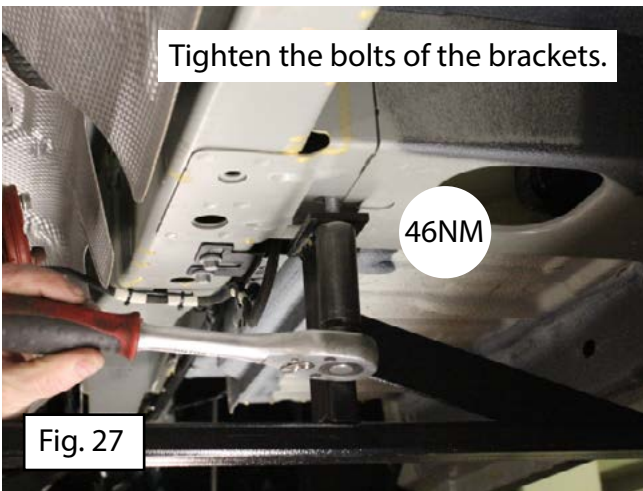


Fig. 26 Do not tighten it yet.



Tighten the bolts of the brackets.

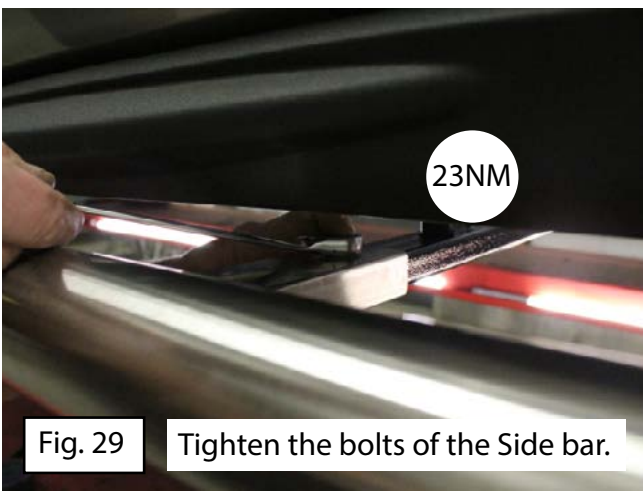
46NM

Fig. 27



Slide the Side bar to the desired distance.

Fig. 28

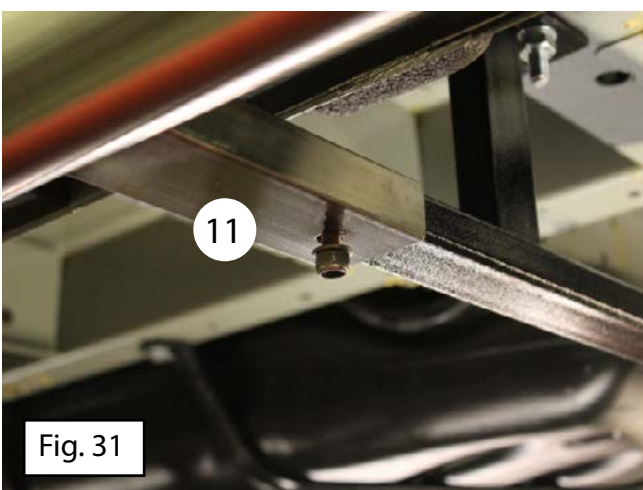


23NM

Fig. 29 Tighten the bolts of the Side bar.

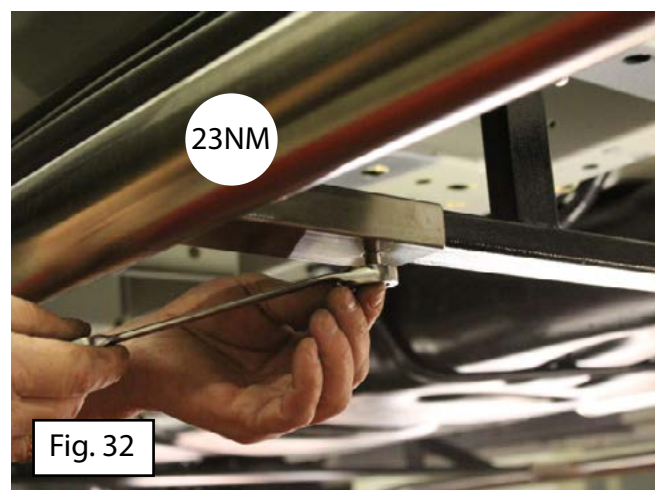


Fig. 30 Use grease



11

Fig. 31



23NM

Fig. 32

# Matching accessories:

